

Eyebolts - Fine Thread, Shoulder Pattern

Drop Forged Carbon Steel, Self-Colored
 ASTM A489
 Fully Threaded: UNF-2A

Stock No.	A Shank Dia. & Thread UNF-2A	B Shank Length	C Eye I.D.	D Eye O.D.	Weight Lbs.	Price Per Piece			
						1-99	100-499	500-999	1000+
K2021-UNF	1/4-28	1	3/4	1 3/16	0.06				
K2022-UNF	5/16-24	1 1/8	7/8	1 7/16	0.11				
K2023-UNF	3/8-24	1 1/4	1	1 21/32	0.18				
K2024-UNF	7/16-20	1 3/8	1 3/32	1 27/32	0.23				
K2025-UNF	1/2-20	1 1/2	1 3/16	2 1/16	0.35				
K2026-UNF	9/16-18	1 5/8	1 9/32	2 9/32	0.47				
K2027-UNF	5/8-18	1 3/4	1 3/8	2 1/2	0.70				
K2028-UNF	3/4-16	2	1 1/2	2 13/16	1.10				
K2029-UNF	7/8-14	2 1/4	1 11/16	3 1/4	1.70				
K2030-UNF	1-12	2 1/2	1 13/16	3 9/16	2.36				
K2030-UNS	1-14	2 1/2	1 13/16	3 9/16	2.36				
K2032-UNF	1 1/4-12	3	2 3/16	4 7/16	4.68				

(Combination pricing on Fine Thread Eyebolts)

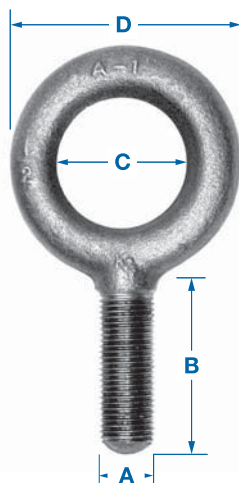

Eyebolts - Fine Thread, Plain Pattern

Drop Forged Carbon Steel, Self-Colored
 ASTM A489
 Fully Threaded: UNF-2A

Stock No.	A Shank Dia. & Thread UNF-2A	B Shank Length	C Eye I.D.	D Eye O.D.	Weight Lbs.	Price Per Piece			
						1-99	100-499	500-999	1000+
K2001-UNF	1/4-28	1	3/4	1 3/16	0.06				
K2002-UNF	5/16-24	1 1/8	7/8	1 7/16	0.10				
K2003-UNF	3/8-24	1 1/4	1	1 21/32	0.15				
K2004-UNF	7/16-20	1 3/8	1 3/32	1 27/32	0.21				
K2005-UNF	1/2-20	1 1/2	1 3/16	2 1/16	0.30				
K2007-UNF	5/8-18	1 3/4	1 3/8	2 1/2	0.61				
K2008-UNF	3/4-16	2	1 1/2	2 13/16	0.98				
K2009-UNF	7/8-14	2 1/4	1 11/16	3 1/4	1.53				
K2010-UNS	1-14	2 1/2	1 13/16	3 9/16	2.06				

(Combination pricing on Fine Thread Eyebolts)

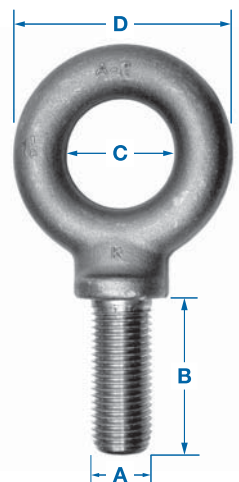

Eyebolts - 8 & 6 Threads Per Inch, Shoulder & Plain Pattern

Drop Forged Carbon Steel, Self-Colored
 ASTM A489
 Fully Threaded: 8 T.P.I.

Stock No.	A Shank Dia. & Thread Spec T.P.I.	B Shank Length	C Eye I.D.	D Eye O.D.	Rated Capty. Lbs.	Weight Lbs.	Price Each
K2031-8 SPEC.	1 1/8-8	2 3/4	2	4	12,000	3.45	
K2032-8 SPEC.	1 1/4-8	3	2 3/16	4 7/16	15,000	4.62	
K2033-6 SPEC.	1 3/8-6	3 1/2	2 1/2	5 3/16	17,900	7.53	
K2033-8 SPEC.	1 3/8-8	3 1/2	2 1/2	5 3/16	17,900	7.24	
K2034-8 SPEC.	1 1/2-8	3 1/2	2 1/2	5 3/16	21,000	7.53	
K2038-8 SPEC.	1 5/8-8	3 3/4	2 7/8	6 1/16	24,300	11.32	
K2035-8 SPEC.	1 3/4-8	3 3/4	2 7/8	6 1/16	28,000	11.95	
K2039-8 SPEC.	1 7/8-8	4	3 1/4	6 7/8	34,500	16.83	
K2036-8 SPEC.	2-8	4	3 1/4	6 7/8	38,000	16.70	
K2037-8 SPEC.	2 1/2-8	5	4	8 9/16	56,000	29.80	
Plain Pattern							
K2015-8 SPEC.	1 3/4-8	3 3/4	2 7/8	6 1/6	28,000	11.00	
K2016-8 SPEC.	2-8	4	3 1/4	6 7/8	38,000	16.25	
K2017-8 SPEC.	2 1/2-8	5	4	8 9/16	56,000	28.00	